

COMM. NO. 15486
CK'D. BY: L.H. AND R.C.W.

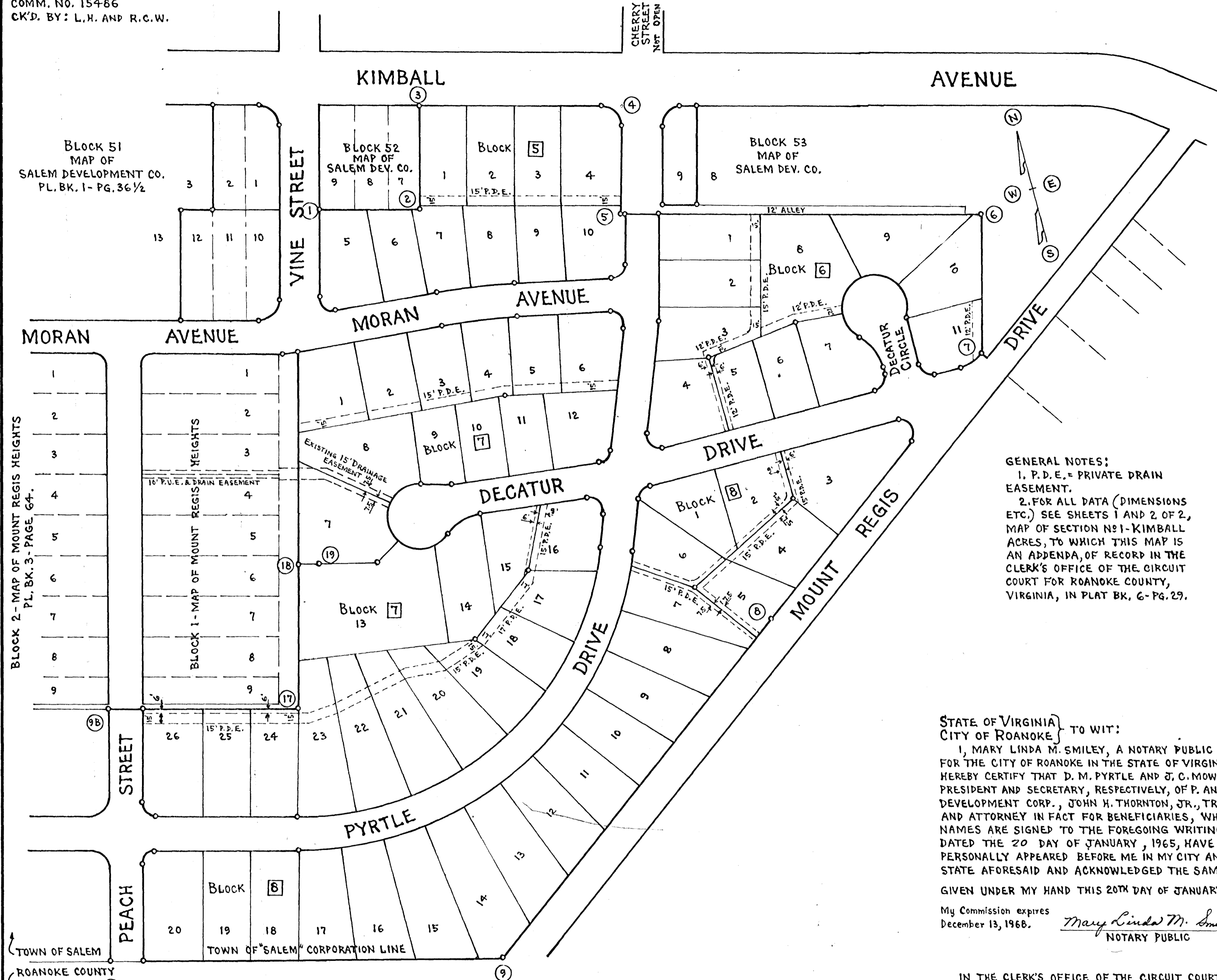

KNOW ALL MEN BY THESE PRESENTS, To Wit:
THAT P. AND M. DEVELOPMENT CORP. IS THE FEE SIMPLE OWNER AND PROPRIETOR OF THE LAND HEREON SHOWN SUBDIVIDED AND KNOWN AS MAP OF SECTION 1 (SHEETS 1 AND 2) KIMBALL ACRES BOUNDED AS SHOWN HEREON BY OUTSIDE CORNERS ① ② ③ ④ ⑤ ⑥ ⑦ ⑧ ⑨ ⑩ ⑪ ⑫ ⑬ ⑭ ⑮ ⑯ ⑰ ⑱ ⑲ ⑳ ㉑ ㉒ ㉓ ㉔ ㉕ ㉖ ㉗ ㉘ ㉙ ㉚ ㉛ ㉜ ㉝ ㉞ ㉟ ㊱ ㊲ ㊳ ㊴ ㊵ ㊶ ㊷ ㊸ ㊹ ㊺ ㊻ ㊼ ㊽ ㊾ ㊿ AND SAID PROPERTY IS OWNED FREE AND CLEAR OF LIENS, SAVE AND EXCEPT THE LIEN OF THAT CERTAIN DEED OF TRUST DATED SEPT. 8, 1964, FROM P. AND M. DEVELOPMENT CORP. TO JOHN H. THORNTON, JR., AND G. MARSHALL MUNDY, TRUSTEES, SECURING GELINE BOWMAN WILLIAMS AND ALEXANDER H. WILLIAMS, JR., HER HUSBAND, BENEFICIARIES, OF RECORD IN THE CIRCUIT COURT FOR THE COUNTY OF ROANOKE, VIRGINIA, IN DEED BOOK 753-PG. 332, JOHN H. THORNTON, JR., BEING THE AGENT AND ATTORNEY IN FACT FOR SAID BENEFICIARIES.
THE SAID OWNER, TRUSTEES, AND AGENT IN FACT FOR THE BENEFICIARIES CERTIFY THAT THE PRIVATE DRAIN EASEMENTS AS APPEAR ON THIS PLAT IS WITH THE CONSENT AND IN ACCORDANCE WITH THE DESIRE OF THE UNDERSIGNED PARTIES.
WITNESS THE SIGNATURE OF P. AND M. DEVELOPMENT CORP. BY D. M. PYRTLE, ITS PRESIDENT, WITH ITS CORPORATE SEAL HERETO AFFIXED AND DULY ATTESTED BY J. C. MOWLES, ITS SECRETARY, AND THE SIGNATURES AND SEALS OF JOHN H. THORNTON, JR., TRUSTEE AND ATTORNEY IN FACT FOR SAID BENEFICIARIES THIS 20TH DAY OF JANUARY, 1965.

P. AND M. DEVELOPMENT CORP.
BY: *D. M. Pyrtle*
D. M. PYRTLE, PRESIDENT.

ATTEST:
J. C. Mowles
J. C. MOWLES, SECRETARY.
John H. Thornton, Jr.
JOHN H. THORNTON, JR., TRUSTEE
ATTORNEY IN FACT FOR BENEFICIARIES

GENERAL NOTES:
1. P.D.E. = PRIVATE DRAIN EASEMENT.
2. FOR ALL DATA (DIMENSIONS ETC.) SEE SHEETS 1 AND 2 OF 2, MAP OF SECTION NO. 1-KIMBALL ACRES, TO WHICH THIS MAP IS AN APPENDIX, OF RECORD IN THE CLERK'S OFFICE OF THE CIRCUIT COURT FOR ROANOKE COUNTY, VIRGINIA, IN PLAT BK. 6-PG. 29.

APPROVED:

F. A. Spiggle 3-10-65
EXECUTIVE SECRETARY OF TOWN OF SALEM PLANNING COMMISSION
DATE
F. A. Spiggle 3-10-65
TOWN ENGINEER OF TOWN OF SALEM, VA. DATE

STATE OF VIRGINIA
CITY OF ROANOKE TO WIT:
I, MARY LINDA M. SMILEY, A NOTARY PUBLIC IN AND FOR THE CITY OF ROANOKE IN THE STATE OF VIRGINIA DO HEREBY CERTIFY THAT D. M. PYRTLE AND J. C. MOWLES, PRESIDENT AND SECRETARY, RESPECTIVELY, OF P. AND M. DEVELOPMENT CORP., JOHN H. THORNTON, JR., TRUSTEE AND ATTORNEY IN FACT FOR BENEFICIARIES, WHOSE NAMES ARE SIGNED TO THE FOREGOING WRITING DATED THE 20 DAY OF JANUARY, 1965, HAVE EACH PERSONALLY APPEARED BEFORE ME IN MY CITY AND STATE AFORESAID AND ACKNOWLEDGED THE SAME.
GIVEN UNDER MY HAND THIS 20TH DAY OF JANUARY, 1965.
My Commission expires
December 13, 1968. *Mary Linda M. Smiley*
NOTARY PUBLIC

CAPTION LEGAL REFERENCE:
THE AREA BOUNDED BY CORNERS ① ② ③ ④ ⑤ ⑥ ⑦ ⑧ ⑨ ⑩ ⑪ ⑫ ⑬ ⑭ ⑮ ⑯ ⑰ ⑱ ⑲ ⑳ ㉑ ㉒ ㉓ ㉔ ㉕ ㉖ ㉗ ㉘ ㉙ ㉚ ㉛ ㉜ ㉝ ㉞ ㉟ ㊱ ㊲ ㊳ ㊴ ㊵ ㊶ ㊷ ㊸ ㊹ ㊺ ㊻ ㊼ ㊽ ㊾ ㊿ AND ADJOINING PART OF CLOSED ALLEY IN BLOCK 51-MAP OF SALEM DEVELOPMENT COMPANY'S PROPERTY CONVEYED FROM GELINE BOWMAN WILLIAMS AND ALEXANDER H. WILLIAMS, JR., HER HUSBAND, TO P. AND M. DEVELOPMENT CORP. BY DEED DATED AUGUST 31, 1964, AND RECORDED IN THE CLERK'S OFFICE OF THE CIRCUIT COURT FOR ROANOKE COUNTY, VIRGINIA, IN DEED BOOK 753-PAGE 326.

RESERVATIONS AND RESTRICTIONS
THE FOLLOWING ADDENDUM RESERVATION AND RESTRICTION NO. 11 TO THE 10 RESERVATIONS AND RESTRICTIONS AS SHOWN ON SHEET 2 OF 2 SHEETS-MAP OF SECTION NO. 1-KIMBALL ACRES, OF RECORD IN THE CLERK'S OFFICE OF THE CIRCUIT COURT FOR ROANOKE COUNTY, VIRGINIA, IN PLAT BOOK 6-PAGE 29, SHALL BE COVENANT RUNNING WITH THE TITLE TO THIS LAND SHOWN HEREON SUBDIVIDED FOR A PERIOD OF 30 YEARS FOLLOWING THE RECORDATION OF THIS MAP.
11. ALL LOTS ARE SUBJECT TO THE PRIVATE DRAIN EASEMENTS AS SHOWN ON BODY OF THIS MAP, AS WELL AS A FIVE FT. WIDTH EASEMENT ALONG ALL OTHER SIDELINES OF EVERY LOT SHOWN HEREON (10 FT. WIDTH TOTAL) WHICH IS ALSO DESIGNATED AS A PRIVATE DRAIN EASEMENT. THE PART OF AFOREMENTIONED RESERVATION & RESTRICTION NO. 10 PERTINENT TO DRAINAGE FACILITIES SHALL APPLY WITH FULL FORCE AND EFFECT TO THE PRIVATE DRAIN EASEMENTS ALONG ALL SIDE LOT LINES AND AS SHOWN HEREON. THIS COVENANT SHALL NOT BE CONSTRUED AS PREVENTING THE USE OF THE SIDE FIVE FT. WIDTH OF THESE LOTS FOR DRIVEWAY PURPOSES. THE PRIVATE DRAIN EASEMENT AREA OF EACH LOT AND ALL IMPROVEMENTS IN IT RE DRAINAGE SHALL BE MAINTAINED CONTINUOUSLY BY THE OWNER OF THE LOT.

IN THE CLERK'S OFFICE OF THE CIRCUIT COURT FOR THE COUNTY OF ROANOKE, VIRGINIA, THIS MAP IS PRESENTED ON 19, AND WITH THE CERTIFICATE OF ACKNOWLEDGMENT THERETO ANNEXED IS ADMITTED TO RECORD AT O'CLOCK M.

TESTE: N.C. LOGAN
CLERK

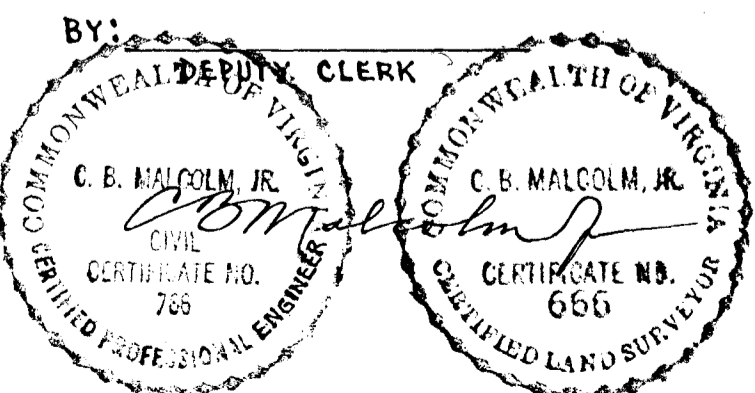

MAP OF SECTION NO. 1
ADDENDA TO SHEET 2 OF 2 SHEETS
KIMBALL ACRES
SHOWING PRIVATE DRAIN EASEMENTS
PROPERTY OF P. AND M. DEVELOPMENT CORP.
SALEM, VIRGINIA.

BY: C. B. MALCOLM & SON
STATE CERT. ENGRS.
ROANOKE, VIRGINIA.

DATE: JANUARY 20, 1965. SCALE: 1"=100'.