

KNOW ALL MEN BY THESE PRESENTS TO WIT:

THAT ROBERT L. HUMPHREY AND LINDA VEST HUMPHREY ARE THE OWNERS OF A 1.51 ACRE TRACT & 16' STRIP TRACT, BOUNDED BY OUTSIDE CORNERS 1 THRU 6, 9 THRU 12 TO 1 INCLUSIVE, BEING THE PROPERTY CONVEYED TO SAID OWNERS BY ROBERT E. HUMPHREY AND WILLIS L. HUMPHREY BY DEED FEBRUARY 1, 1980 AND RECORDED IN THE CLERK'S OFFICE OF THE CIRCUIT COURT OF THE CITY OF SALEM, VIRGINIA IN DEED BOOK 118, PAGE 715.

THAT WILLIAM D. HUMPHREY AND MARGARET TILLMAN HUMPHREY ARE THE OWNERS OF A 1.200 ACRE TRACT, BOUNDED BY OUTSIDE CORNER CORNERS 8, 9, 6, 7 TO 8 INCLUSIVE, BEING THE PROPERTY CONVEYED TO SAID OWNERS BY ROBERT E. HUMPHREY AND WILLIS L. HUMPHREY BY DEED DATED FEBRUARY 1, 1980 AND RECORDED IN THE CLERK'S OFFICE OF THE CIRCUIT COURT OF THE CITY OF SALEM, VIRGINIA IN DEED BOOK 118, PAGE 712.

THE SAID OWNERS HEREBY CERTIFY THAT THEY HAVE RESUBDIVIDED THE PROPERTIES OF THEIR OWN FREE WILL AND ACCORD AS REQUIRED BY SECTIONS 15.2-2240 THRU 15.2-2279 OF THE 1950 CODE OF VIRGINIA AS AMENDED TO DATE AND THE CITY OF SALEM SUBDIVISION ORDINANCE AS AMENDED TO DATE AND VACATE LINES 6-9 AND 12-3 SHOWN DOTTED HEREON.

WITNESS THE SIGNATURES AND SEALS OF SAID OWNERS:

Robert L. Humphrey 12-9-2010
ROBERT L. HUMPHREY - OWNER DATE
DEED BOOK 118, PAGE 715

William D. Humphrey 12-10-2010
WILLIAM D. HUMPHREY - OWNER DATE
DEED BOOK 118, PAGE 712

Margaret Tillman Humphrey 12-10-2010
MARGARET TILLMAN HUMPHREY - OWNER DATE
DEED BOOK 118, PAGE 712

STATE OF VIRGINIA
County of Roanoke

TO WIT:
I, Rose Lee Nichols, A NOTARY PUBLIC IN AND FOR THE AFORESAID STATE DO HEREBY CERTIFY THAT ROBERT L. HUMPHREY, WHOSE NAME IS SIGNED TO THE FOREGOING WRITING HAS PERSONALLY APPEARED BEFORE ME AND ACKNOWLEDGED THE SAME IN MY AFORESAID JURISDICTION ON THIS 9 DAY OF December 2010.

Rose Lee Nichols
NOTARY PUBLIC, DATE & SEAL
REGISTRATION #: 325747

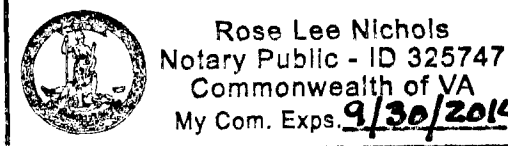

STATE OF VIRGINIA
County of Roanoke

TO WIT:
I, Rose Lee Nichols, A NOTARY PUBLIC IN AND FOR THE AFORESAID STATE DO HEREBY CERTIFY THAT WILLIAM D. HUMPHREY, WHOSE NAME IS SIGNED TO THE FOREGOING WRITING HAS PERSONALLY APPEARED BEFORE ME AND ACKNOWLEDGED THE SAME IN MY AFORESAID JURISDICTION ON THIS 10 DAY OF December 2010.

Rose Lee Nichols
NOTARY PUBLIC, DATE & SEAL
REGISTRATION #: 325747

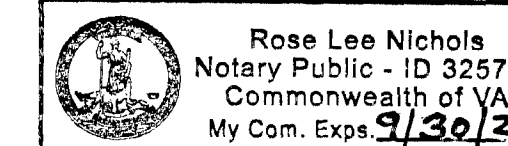

STATE OF VIRGINIA
County of Roanoke

TO WIT:
I, Rose Lee Nichols, A NOTARY PUBLIC IN AND FOR THE AFORESAID STATE DO HEREBY CERTIFY THAT MARGARET TILLMAN HUMPHREY, WHOSE NAME IS SIGNED TO THE FOREGOING WRITING HAS PERSONALLY APPEARED BEFORE ME AND ACKNOWLEDGED THE SAME IN MY AFORESAID JURISDICTION ON THIS 10 DAY OF December 2010.

Rose Lee Nichols
NOTARY PUBLIC, DATE & SEAL
REGISTRATION #: 325747

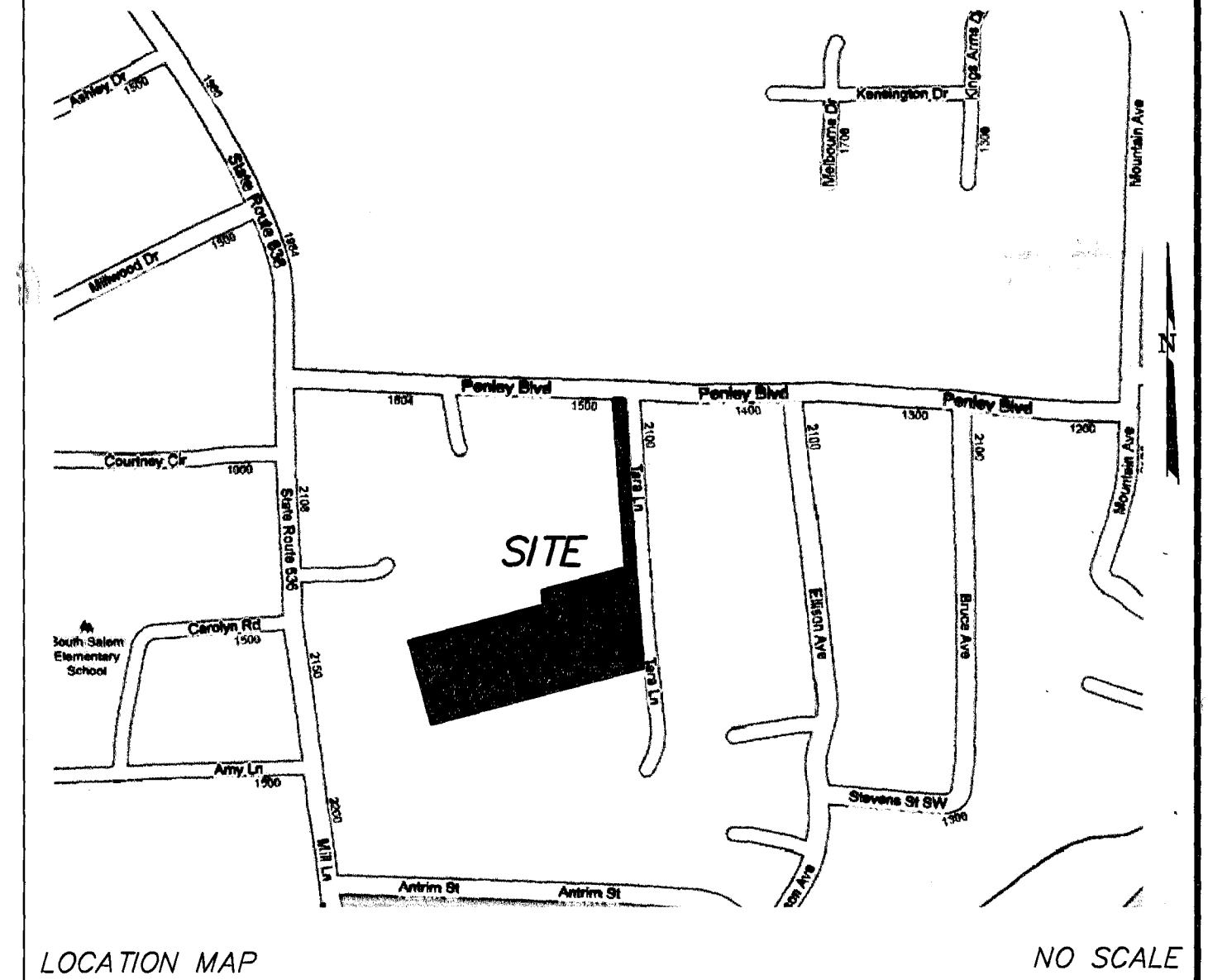
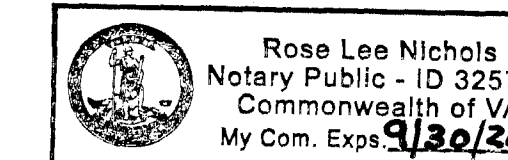

THE RECORDATION OF THIS PLAT OF SUBDIVISION DOES NOT CONSTITUTE A CONVEYANCE OF LAND. ANY LOT, PARCEL OR TRACT OF LAND SHOWN HEREON THAT IS INTENDED FOR SALE AND/OR CONVEYANCE MUST BE CONVEYED BY DEED AND SAID DEED MUST BE RECORDED IN THE OFFICE OF THE CLERK OF CIRCUIT COURT OF THE CITY OF SALEM.

APPROVED:
James E. Taliaferro, II 12/20/10
JAMES E. TALIAFERRO, II, P.E., L.S. DATE
EXECUTIVE SECRETARY CITY OF SALEM PLANNING COMMISSION

Charles E. Van Allman, Jr. 12/17/10
CHARLES E. VAN ALLMAN, JR., P.E., L.S. - CITY ENGINEER DATE
CITY OF SALEM, VIRGINIA

IN THE CLERK'S OFFICE OF THE CIRCUIT COURT OF THE CITY OF SALEM, VIRGINIA THIS MAP WAS PRESENTED WITH THE CERTIFICATE OF ACKNOWLEDGEMENT THERETO ATTACHED ADMITTED TO RECORD AT 11:45 O'CLOCK 9 A.M. ON THIS 20th DAY OF December 2010.

TESTE: CHANCE CRAWFORD
CLERK

BY: Elyse M. Kelly
DEPUTY CLERK

GENERAL NOTES:

1. THIS PLAT WAS PREPARED WITHOUT BENEFIT OF A TITLE REPORT AND IS SUBJECT THERETO. THEREFORE, THERE MAY EXIST ENCUMBRANCES WHICH AFFECT THE PROPERTY NOT SHOWN HEREON.
2. THE SUBJECT PROPERTY IS WITHIN THE LIMITS OF ZONE "X UNSHADED" AS SHOWN ON THE FEMA FLOOD INSURANCE RATE MAP PANEL NO. 51161C0139 G, EFFECTIVE DATE SEPTEMBER 28, 2007. THIS DETERMINATION IS BASED ON SAID MAP AND HAS NOT BEEN VERIFIED BY ACTUAL FIELD ELEVATIONS.
3. THE PROPERTIES ARE ZONED RSF (RESIDENTIAL SINGLE FAMILY) AS OF THE DATE OF THIS PLAT.
4. PIN SET BY PARKER DESIGN GROUP IS 1/2" DIAMETER BY 18" LONG REINFORCING ROD DRIVEN TO 2 INCHES ABOVE GROUND WITH PLASTIC ORANGE CAP ON TOP WITH "PARKER DESIGN" EMBOSSED.

GENERAL NOTES:

GENERAL NOTES:

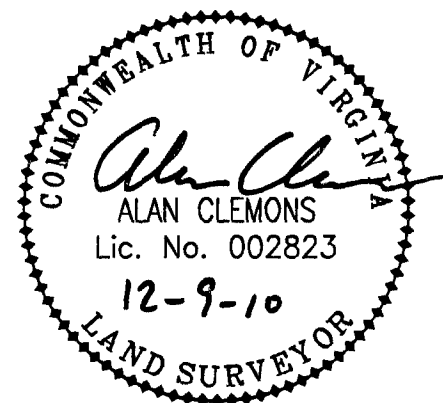

THIS PLAT IS BASED ON A FIELD SURVEY PERFORMED SEPTEMBER 22, 2010. ROBERT L. & LINDA VEST HUMPHREY (D.B. 118, PG. 715) AND WILLIAM D. & MARGARET TILLMAN HUMPHREY (D.B. 118, PG. 712) ARE THE OWNERS OF RECORD.

PLAT OF SURVEY FOR
**ROBERT L. HUMPHREY AND
WILLIAM D. HUMPHREY &
MARGARET TILLMAN HUMPHREY**

SHOWING THE VACATION AND COMBINATION BETWEEN A 1.379 ACRE (1.51 ACRE BY RECORDS) LOT & A 16' STRIP (0.105 ACRE) BEING 1.484 ACRE TOTAL
D.B. 118, PG. 715
AND A 1.20 ACRE TRACT (D.B. 118, PG. 712) CREATING HEREON LOT 1 (0.755 ACRE) AND LOT 2 (1.929 ACRES)
SITUATE ON TARA LANE (PRIVATE ROAD) & MILL LANE CITY OF SALEM, VIRGINIA
SCALE: 1"=40'

TAX #: 213-1-24 & 212-2-10 DATE: DECEMBER 9, 2010
DRAWN: REC W.O.: 10-0122-02
CALC.: REC PAGE 1 OF 2



PLAT OF SURVEY FOR ROBERT L. HUMPHREY AND WILLIAM D. HUMPHREY & MARGARET TILLMAN HUMPHREY

SHOWING THE VACATION AND COMBINATION BETWEEN A
1.379 ACRE (1.51 ACRE BY RECORDS) LOT & A 16' STRIP (0.105 ACRE)
BEING 1.484 ACRE TOTAL
D.B. 118, PG. 715
AND A 1.20 ACRE TRACT (D.B. 118, PG. 712)
CREATING HEREON LOT 1 (0.755 ACRE) AND
LOT 2 (1.929 ACRES)
SITUATE ON TARA LANE (PRIVATE ROAD) & MILL LANE
CITY OF SALEM, VIRGINIA
SCALE: 1"=40'

TAX #: 213-1-24 & 212-2-10 DATE: DECEMBER 9, 2010
DRAWN: REC W.O.: 10-0122-02
CALC.: REC PAGE 2 OF 2

parker
DESIGN GROUP
ENGINEERS * SURVEYORS * PLANNERS * LANDSCAPE ARCHITECTS
816 Boulevard
Salem, Virginia 24153
Phone: 540-387-1153
Fax: 540-389-5767
www.parkerdg.com

MERIDIAN OF
D.B. 118, PG. 715

LEGEND:

- MONUMENT FOUND
- DEEDED CORNER
- POWER POLE
- SANITARY SEWER MANHOLE

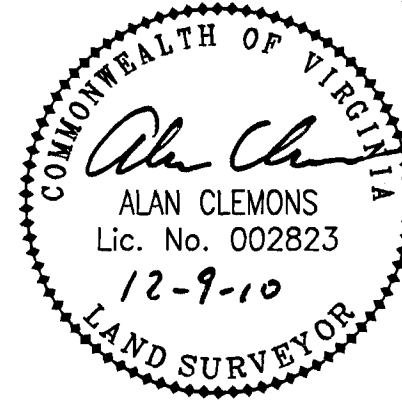
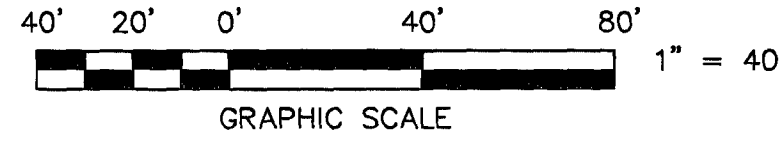

PENLEY BOULEVARD
50' WIDE (PUBLIC)

