

LEGEND
 ○ IRON PIN SET
 ● IRON PIN FOUND
 D.B. 4, PG. 777
 SCALE: 1" = 100'

THIS IS TO CERTIFY THAT AN ACCURATE FIELD SURVEY OF THE PREMISES SHOWN HEREON HAS BEEN PERFORMED UNDER MY SUPERVISION; THAT ALL IMPROVEMENTS AND VISIBLE EVIDENCE OF EASEMENTS ARE SHOWN HEREON, AND THAT THERE ARE NO ENCROACHMENTS BY IMPROVEMENTS EITHER FROM ADJOINING PREMISES OR FROM SUBJECT PREMISES OTHER THAN SHOWN HEREON. THIS SURVEY WAS PERFORMED WITHOUT THE BENEFIT OF A TITLE REPORT AND IS SUBJECT TO INFORMATION WHICH MAY BE DISCLOSED BY SUCH PROPERTY IS IN F.E.M.A. DEFINED ZONE UNSHADED X

NORTH
 N/F
 SAMUEL, JR. & LOLA C. MORGAN
 TAX # 27-2-3

N/F
 JOHN THOMAS HANCOCK, JR.
 TAX # 37-1-1

N/F
 RICHARD L. LEWIS
 TAX # 37-1-4

TAX #
 38-5-3
 3.058
 ACRES

N/F
 BOOTH-AMERICAN COMPANY
 TAX # 37-1-8

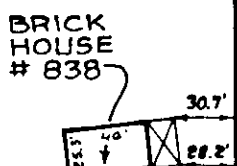

In the Clerk's Office of the Circuit Court for the City of Salem, this 3rd day of June 1996 this PLAT was presented and with the Certificate of acknowledgement thereto annexed admitted to record 3:47 o'clock P. M. TESTE: Chance Crawford Clerk

DEVELOPERS SUBDIVISION BUILDERS & DEVELOPERS P.B. 3, PG. 57 LOT 3 LOT 4A

Murda (V. J. J.) Dep. Clerk

- NOTES:
 1. OWNER OF RECORD: WILLIAM R. SHEPHERD, SR. THERESA S. SHEPHERD
 2. LEGAL REFERENCE: DEED BOOK 4, PAGE 777
 3. TAX MAP NUMBER: 38-5-3

SURVEY FOR
 WILLIAM R. SHEPHERD, SR.

838 CRAIG AVENUE
 3.058 ACRES AS DESCRIBED IN. D.B. 4, PG. 777
 CITY OF SALEM, VIRGINIA
 MAY 20, 1996
 JOB NUMBER R9620555

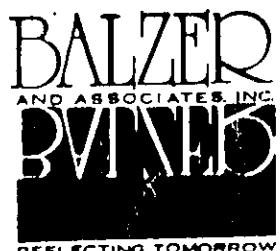
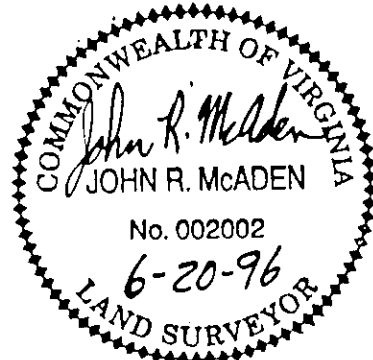

PLANNERS ARCHITECTS ENGINEERS SURVEYORS
 1208 CORPORATE CIRCLE, ROANOKE, VIRGINIA 772-9580

591939